



K2BC4E280/80A MOTORIZED IMPELLER

TECHNICAL DATA

Model	CFM@ Cutoff		Volts	Hz	Amps	Watts	Capacitor		RPM	dBA	Min. Temp.	Max. Temp.
	0" S.P.	S.P.					μF					
K2BC4E280/80A	947	1.04	230	60	0.44	91	2.5	1585	66	-40°F/-40°C	140°F/60°C	
K2BC4E280/80A	829	0.76	230	50	0.41	86	2.5	1365	63	-40°F/-40°C	122°F/50°C	



STANDARD FEATURES

- Low noise level
- 947 CFM capacity
- Available in 230 VAC, 50/60Hz
- Compact size
- Precision balanced
- External rotor design
- Precision ball-bearing motors
- Class F, thermally protected
- Galvanized Steel impeller
- UL Recognized
- Normally In-Stock

ACCESSORIES*

- Capacitor - P/N: 0452-107
- Inlet Ring - P/N: 970-367-12GLV

PERFORMANCE

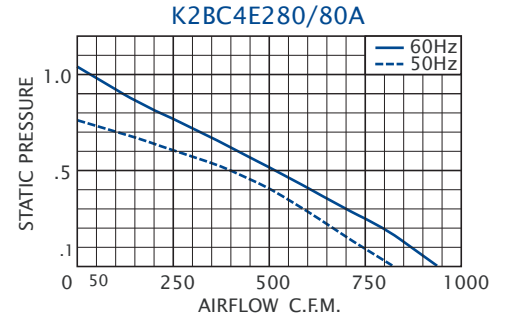

Airflow vs. static pressure curves are shown for 60 Hz and 50 Hz (broken line) inputs. Static pressure is in inches of water.

DRAWINGS

Dimensions, inches [mm], are for reference only and are subject to change.

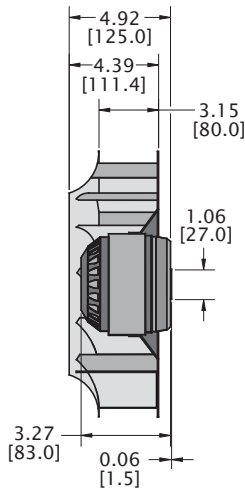
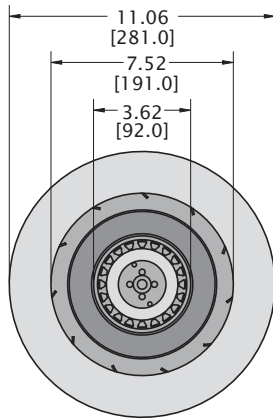

An inlet ring, which must be installed by the customer, is recommended for optimum performance. This unit requires a capacitor which must be mounted and connected by the customer.

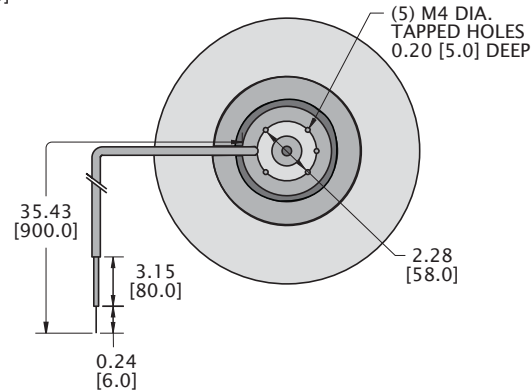

INLET RING P/N: 970-367-12GLV

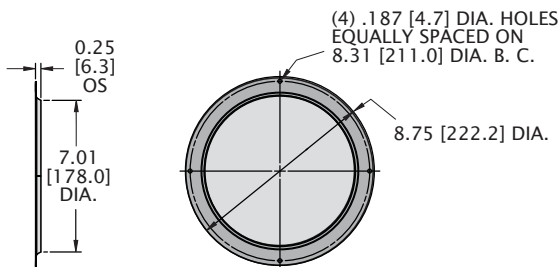

TYPICAL INSTALLATION

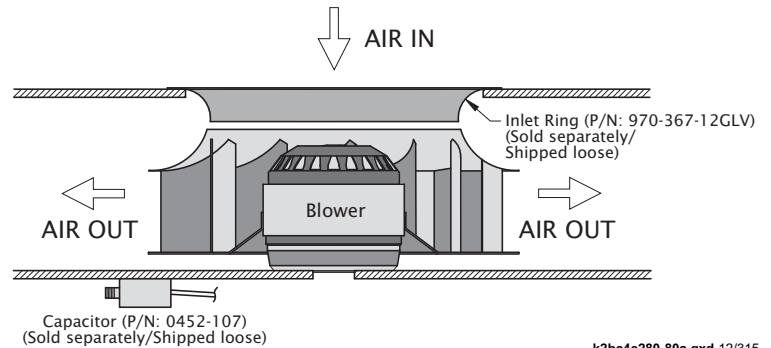

k2bc4e280-80a.qxd 12/315