

K2BC4R355/127C MOTORIZED IMPELLER

TECHNICAL DATA

Model	CFM@ 0" S.P.	Cutoff S.P.	Volts	Hz	Amps	Watts	Capacitor μF	RPM	dBA	Max. Temp
K2BC4R355/127C	1740	1.5	230	50	1.50	340	8.0	1360	76	140°F/60°C
K2BC4R355/127C	2070	2.1	230	60	2.15	490	8.0	1480	78	113°F/45°C



STANDARD FEATURES

2070 CFM Capacity
Available in 230 VAC, 50/60Hz
Compact size
External rotor design
Low noise level
Normally In-Stock
Precision balanced
Precision ball-bearing motors

ACCESSORIES*

Automatic Speed Control
Capacitor - P/N: 0452-76
Inlet Ring - P/N: 1114-12



***Note:** This unit requires a capacitor for operation. Capacitors are sold separately and shipped loose for field installation by customer. An Inlet Ring is recommended for optimum performance. These are sold separately, to be installed by the customer.

PERFORMANCE

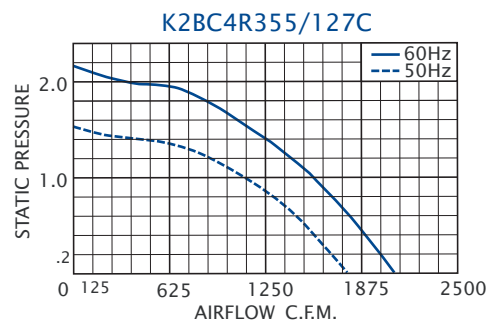

Airflow vs. static pressure curves are shown for 60 Hz (solid line) and 50 Hz (broken line) inputs. Static pressure is in inches of water.

DRAWINGS

Dimensions, inches [mm], are for reference only and are subject to change.

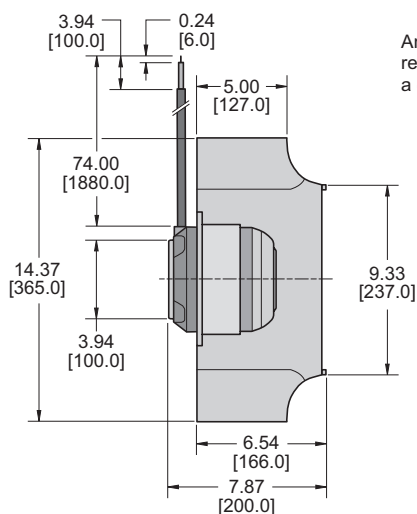

An inlet ring, which must be installed by the customer, is recommended for optimum performance. This unit requires a capacitor which must be connected by the customer.

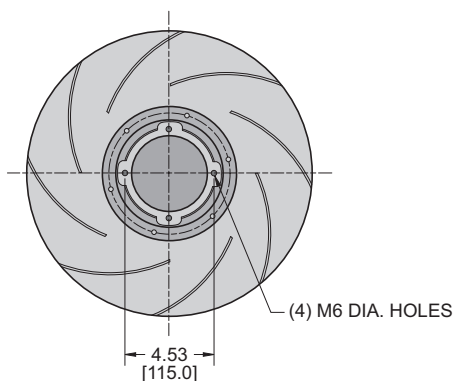

OPTIONAL INLET RING P/N: 0431-04P

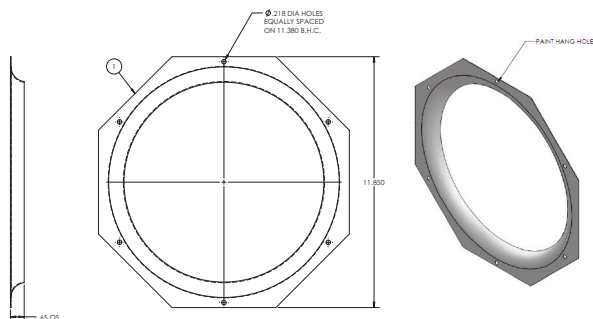

TYPICAL INSTALLATION

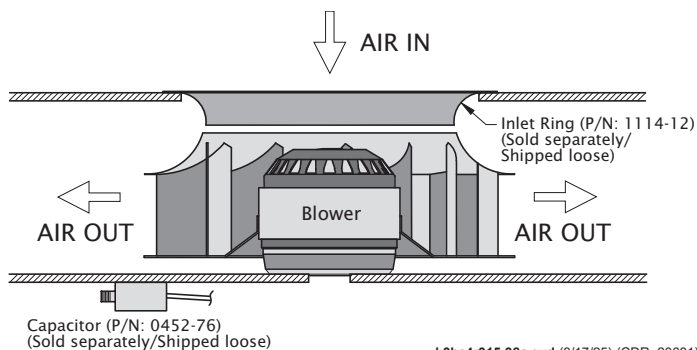

k3bc4r315-98a.qxd (3/17/25) (CDR: 20631)