



KBC4E280/80B MOTORIZED IMPELLER

TECHNICAL DATA

Model	CFM@ Cutoff		Volts	Hz	Amps	Watts	Capacitor		RPM	dBA	Min. Temp.	Max. Temp.
	0" S.P.	S.P.					µF	RPM				
KBC4E280/80B	944	1	115	60	0.94	101	10.0	1490	66	-40°F/-40°C	122°F/50°C	
KBC4E280/80B	820	0.72	115	50	0.97	92	10.0	1310	63	-40°F/-40°C	122°F/50°C	



STANDARD FEATURES

- 944 CFM Capacity
- Available in 115 VAC, 50/60Hz
- Class F, thermally protected
- Compact size
- External rotor design
- Galvanized Steel impeller
- Low noise level
- Normally In-Stock
- Precision balanced
- Precision ball-bearing motors
- UL Recognized



ACCESSORIES*

- Automatic Speed Control
- Capacitor - P/N: 0452-62
- Inlet Ring - P/N: 1114-11



***Note:** This unit requires a capacitor for operation. Capacitors are sold separately and shipped loose for field installation by customer. An Inlet Ring is recommended for optimum performance. These are sold separately, to be installed by the customer.

PERFORMANCE

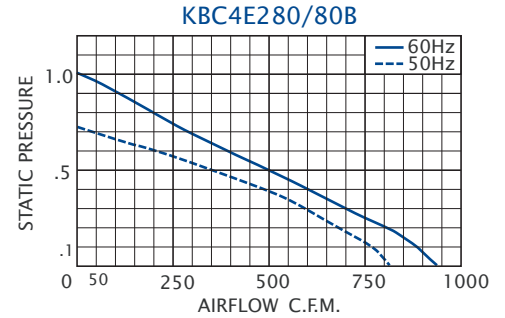

Airflow vs. static pressure curves are shown for 60 Hz (solid line) and 50 Hz (broken line) inputs. Static pressure is in inches of water.

DRAWINGS

Dimensions, inches [mm], are for reference only and are subject to change.

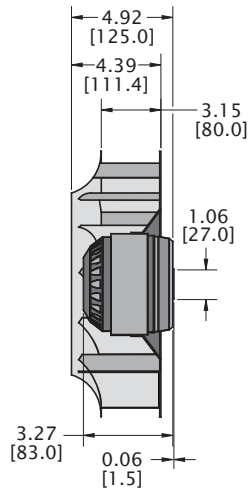
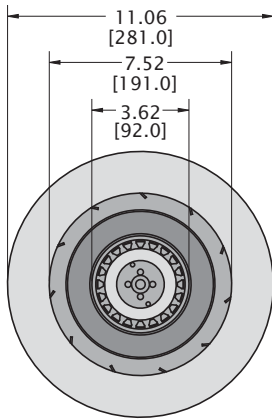

An inlet ring, which must be installed by the customer, is recommended for optimum performance. This unit requires a capacitor which must be mounted and connected by the customer.

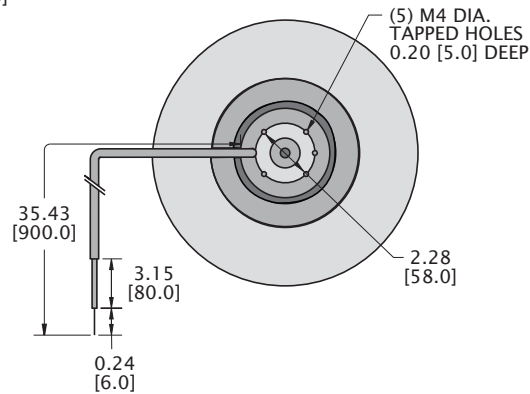

INLET RING P/N: 1114-11

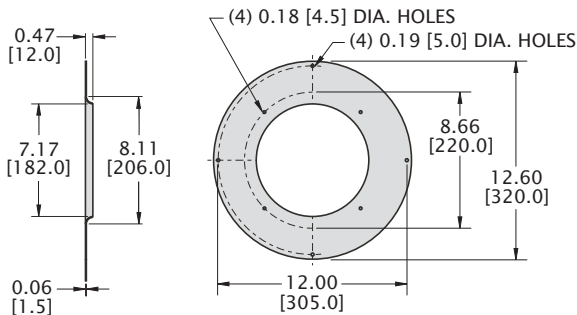

TYPICAL INSTALLATION

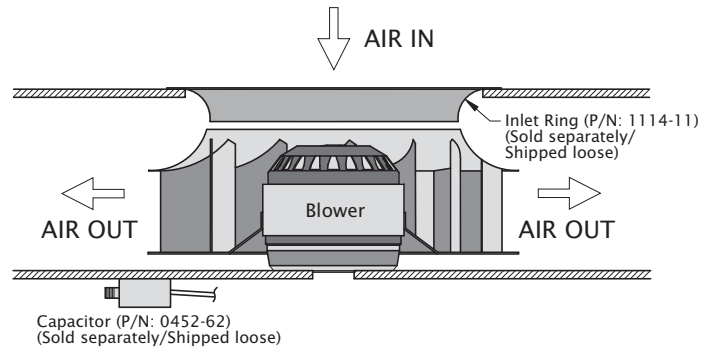

kbc4e280-80b.qxd (7/13/21) (CDR: 20336)