

COMPACT ENCLOSURE LAMP

The KSCL Compact Enclosure Lamp was designed for use in industrial enclosures and control cabinets. A strong magnet allows simple and quick installation and flexibility for various mounting positions.

STANDARD FEATURES

- Magnet or screw mounting
- Energy-saving lamp
- Integrated receptacle
- On/Off switch



Model No.	Voltage	Power
KSCL4/RMS	120 VAC	4W (LED lighting element)
K2SCL11/RS	230 VAC	11W (LED lighting element)

TECHNICAL DATA

Illuminant:	LED
Luminosity:	560 Lm
Service life:	60000 hours
Radio interference suppression grade:	In compliance with VDE 0712 IEC 82
Switch:	On /off light switch
Receptacle:	AC 120V: US receptacle and protective cover AC 230V: Schuko receptacle and protective cover
Connections:	3-pole terminal for AWG 14 max. (2.5 mm ²)
Mounting:	Magnet mounting on painted steel surfaces Holding power approx. 20 kp (on 2 mm sheet metal)
Housing:	Plastic
Protection class:	I (grounded)
Protection type:	IP 20
Operating temperature:	-40°F to 140°F (-40°C to 60°C)



DRAWINGS

Dimensions, inches, are for reference only and are subject to change.

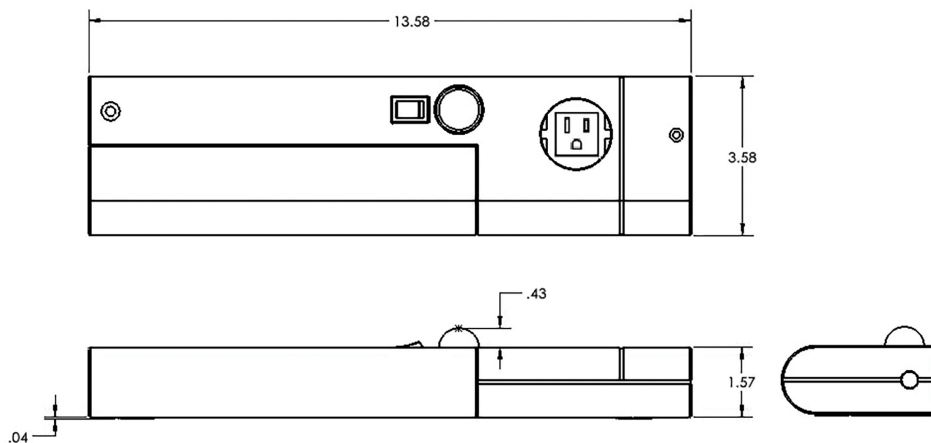

Find additional information on this model at kooltronic.com, or use the Technical Documents QR code below.

Technical Documents



Specifications are subject to change without notice. Suitability of this product for its intended use and any associated risks must be determined by the end customer/buyer in its final application.

kscl.qxd (3/25) (CDR: 20630)